



## **Solar Powered House Light Number KALGHTHOUSA Quick Start Guide**

Please read these instructions carefully and keep handy for future reference.

### **How the light works**

During the day, the solar panel converts solar energy and converts it into power for the rechargeable battery. At night, the light turns on automatically, powered by the stored energy. How long the light stays lit depends on location, weather conditions and seasonal lighting availability.

### **Choosing the right location**

An outdoor location with plenty of direct sunlight, where the panel itself can receive at least six hours of sunshine each day is ideal for a solar light. Shady locations will influence the battery charge and may shorten the working time of the light at night time. The solar light should not be placed near lighting such as street lights, as they may cause the light itself to turn off, as the built-in sensor may mistake this ambient light for daylight.

### **Precautions**

Please note that this light is designed to work when the ambient light has gone dark. If there are strong light sources nearby, the solar light may be dim or not even turn on at all. Although Kogan.com ships the light with some charge in the battery, the levels will be low when you receive it. Please charge it for a full day to optimise performance. The surface of the solar panel itself must be kept clean for efficient charging.

### **Instructions**

1. Remove the light unit and sticker sheets from the packaging. Select the required stickers (your house number/letter details), then remove them from the backing sheet and press them onto the display panel.
2. The ON/OFF switch is located inside the unit. Remove the back panel by undoing the philips head screw (located on the bottom edge) and slide the switch into the ON position before use. Replace the back panel, taking care that it is aligned properly and secured firmly in place with the screw.
3. Mount the light unit onto a wall or fence, using the keyhole shaped openings on the back and hardware included. Ensure that it is positioned in a sunny location with the solar panel (near the top) in direct sunlight.
4. Allow the solar panel to charge the battery for at least 24-48 hours before use. When darkness falls, the LED light inside the unit will light up for several hours (depending on the charge).

5. If the solar light does not come on automatically at nightfall, please check:
- the solar panel is positioned to receive enough sunlight
  - the battery is making good contact with the battery terminals

## Battery

A rechargeable Ni-MH battery (AA 1.2V 600mAh) is included in this product and can be replaced when required. The battery compartment is located inside the unit. To access it, remove the back panel by undoing the screw with a philips head screwdriver and placing it to one side. Remove the exhausted battery, then insert a new rechargeable battery as indicated inside the compartment, then replace the back panel and screw.

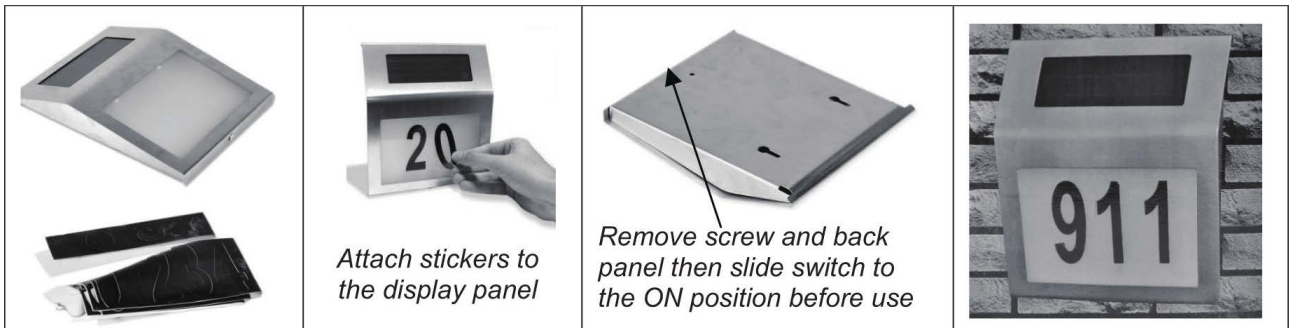

## Materials

Stainless Steel  
PP  
Laminated Paper

If you have any questions or concerns regarding the use of this product, please contact the Kogan.com customer support team.