



Kogan Easy Chef KARPIDCOOKA Quick Start Guide

Safety & Warnings

Handle with care and inspect regularly to ensure product is in good working order.
If this product, power supply cord or plug shows any signs of damage: stop use, unplug the product and contact Kogan.com support.

- Read all instructions before using the appliance and retain for reference.
- This appliance is not intended for use by persons (including children) with reduced physical, sensory or mental capabilities, or lack of experience and knowledge, unless they have been given supervision or instruction concerning use of the appliance by a person responsible for their safety.
- Children should be supervised to ensure that they do not play with the appliance.
- This appliance is designed for consumer use: follow directions and use only as described.
- Do not use with an extension cord unless necessary, and if so, ensure it is suitably rated and it is handled safely as is the product's own power cord:
- The appliance is not intended to be operated by means of an external timer or separate remote-control system.
- Do not allow the power cord to be exposed to water, heat, direct sunlight or overhang where it can be pulled or otherwise be damaged or pose a hazard.
- If the supply cord is damaged, it must be replaced by a special cord or assembly available from the manufacturer or its service agent.
- This appliance is intended for home use only. It is not intended for camping or commercial use. Do not use outdoors.
- This appliance contains no user-serviceable parts. If it suffers any failure or damage, cease usage and contact Kogan Support after consulting the Troubleshooting section of this manual.

Precautions

- When lifting and lowering the cover, always lift from the handle and ensure the cover is either firmly closed or completely upright.
- Never lift the cover so that your arm any part of your body is directly over the cooking surface. Escaping steam can cause serious injury.
- When in use, do not touch or handle any part of the appliance other than the handle itself. Or, allow the appliance to cool suitably before handling the appliance. Hot surfaces can cause serious injury.
- Please treat all use with this appliance with extreme caution.
- Do not use any sharp or metal kitchen utensils on the cooking surfaces - these may damage the appliance.

Product Components

- A. Cooking Surfaces
- B. Latch
- C. Handle
- D. Cover
- E. Red Indicator Light
- F. Green Indicator Light
- G. Power Cord
- H. Spatula

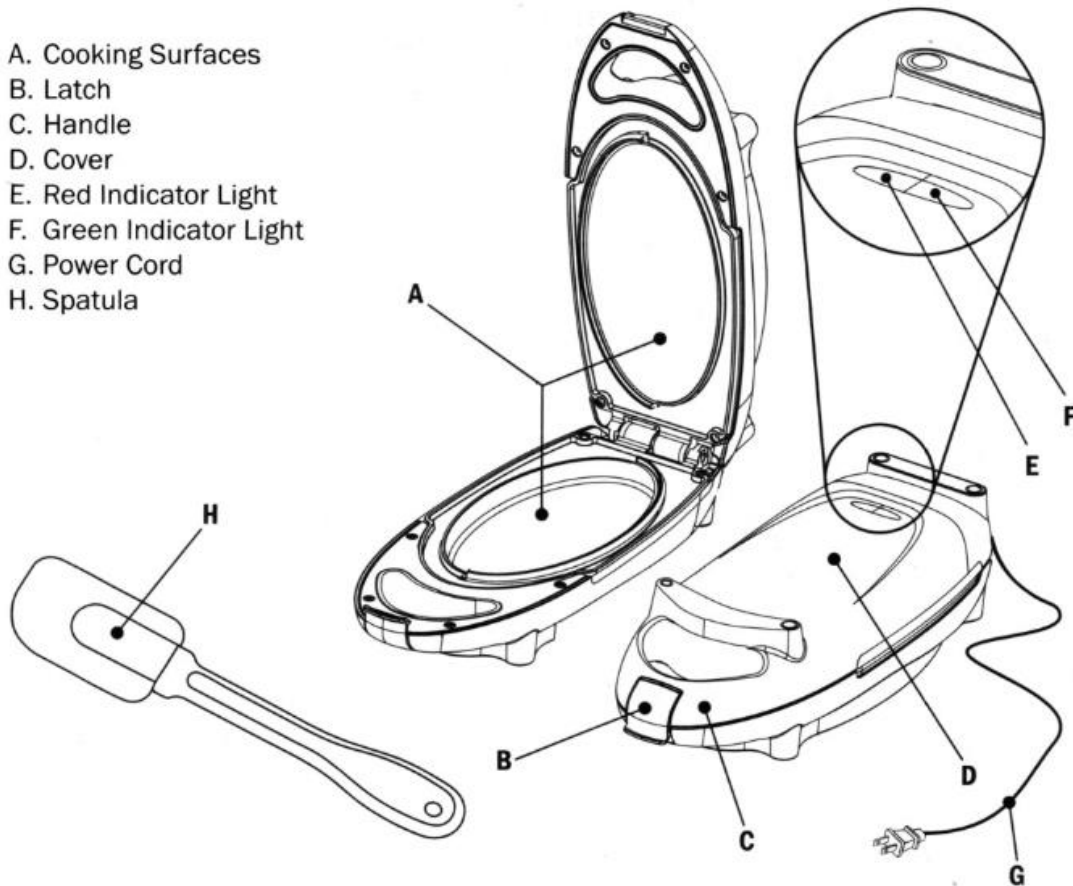

Operation

1. Before first use, please clean all cooking surfaces with a soft sponge that has been dipped into warm soapy water. Dry with a soft towel or allow to air dry. Never immerse the appliance in water.
2. Place the appliance on a flat, dry, sturdy surface, and plug in the power cord.
3. The appliance will automatically turn on and a red indicator light on the top of the cover will illuminate - signifying that the appliance is heating.
4. Once the cooking surface is hot and ready for use, a green indicator light will illuminate.
5. Food may be placed directly onto the cooking surface.
6. If desired, the cover can be closed and the latch locked by pressing down on the latch located on the front of the device until a click is heard. Once locked, you may flip the device to cook the other side of the food in the appliance.
7. The spatula can be used to remove food from the appliance.

Cleaning

- Before performing any sort of cleaning on the appliance, please make sure the appliance is unplugged and let it cool for at least five minutes.
- Do not use any abrasive cleaners or brushes on any of the surfaces.
- Use warm soapy water and a soft sponge to clean the appliance.
- Dry with a soft towel or allow the appliance to air dry.
- If any cooking surface has burnt food stuck on it, a small amount of cooking oil can be poured on the burnt food. Allow the oil to sit for ten minutes, then, simply wipe with a damp cloth.
 - Should the problem persist, try again and wait longer before wiping.
- Before storing the appliance, please ensure that it is completely dry and clean.

User manual is subject to change without notice. For the latest version of your user manual, please visit <https://www.kogan.com/usermanuals/>