



2.0.2 CH 120W DOLBY ATMOS SOUNDBAR

KASBDA20CA

SAFETY & WARNINGS



CAUTION!
RISK OF ELECTRIC SHOCK
DO NOT OPEN



TO REDUCE THE RISK OF ELECTRIC SHOCK DO NOT REMOVE COVER

WARNING: Do not attempt to remove any screws or open the casing of the unit; there are no user-serviceable parts inside. Refer all servicing to qualified service personal.

Servicing is required when the apparatus has been damaged in any way, for example, when the power-supply cord or plug is damaged, liquid has been spilt or objects have fallen into the apparatus, the apparatus has been exposed to rain or moisture, does not operate normally or has been dropped.



The lightning flash within an equilateral triangle is intended to alert you to the presence of uninsulated dangerous voltage within the product's enclosure that may be of sufficient magnitude to constitute an electric shock to a person or persons.



Important! This symbol alerts you to read and observe important warnings and instructions on the unit or in this manual.

Notice:

This appliance is not intended for use by persons (including children) with reduced physical sensory or mental capabilities or lack of experience and knowledge unless they have been given supervision or instruction concerning use of the appliance by a person responsible for their safety. Children should be supervised to ensure that they do not play with the appliance.

Read, keep, and follow all instructions. Heed all warnings and retain this guide for future reference. Operate the product only as instructed within.

- To prevent possible hearing damage, do not listen to high volume levels for long periods or a sudden high-volume level.
- Never use the device unsupervised. Switch off the device whenever you are not using it, even if not using it only for a short while.
- The appliance is not intended to be operated using an external timer or separate remote-control system.
- If the supply cord is damaged, it must be replaced by Kogan.com to avoid a hazard.
- Before operating this system, check the voltage of this system to see if it is identical to the voltage of your local power supply.
- The unit should not be impeded by covering the ventilation opening with items such as newspaper, table-cloths, curtains etc. Make sure that there are at least 20 cm of space above and at least 5 cm of space on each side of the unit.
- The apparatus must not be exposed to dripping or splashing liquid. No objects filled with liquids (such as vases) should be placed on or near the apparatus.
- Avoid extreme temperatures. Do not install near any heat sources such as radiators, heaters, stoves, or other apparatus (including amplifiers) that produce heat.
- To prevent fire or shock hazard, do not expose this equipment to direct heat, rain, moisture, or dust.
- Do not position this unit near any water sources e.g. taps, bathtubs, washing machines or swimming pools. Ensure that you place the unit on a dry, stable surface.
- Do not place this unit close to a strong magnetic field, or on an amplifier or receiver.
- Do not place this unit in a damp area as the moisture will affect the life of electric components.
- Do not attempt to clean the unit with chemical solvents as this might damage the finish. Wipe with a clean, dry, or slightly damp cloth.
- When removing the power plug from the wall outlet, always pull directly on the plug, never pull on the cord.
- Protect the power cord from being walked on or pinched particularly at plugs, convenience receptacles or at the point where they exit from the apparatus.
- Depending on the electromagnetic waves used by a television broadcast, if a TV is turned on near this unit while it is also on, lines might appear on the LED TV. Neither this unit nor the TV is malfunctioning. If you see such lines, keep this unit well away from the TV set.
- The AC plug is used to disconnect the device; the disconnected device should remain readily operable. To disconnect the apparatus from the AC power completely, the AC plug must be removed from the AC outlet completely.
- Only use original or certified cables or attachments/accessories specified by Kogan.com.
- Do not use the device outdoors during thunderstorms, Unplug this apparatus during lightning storms or when unused for long periods.

OVERVIEW

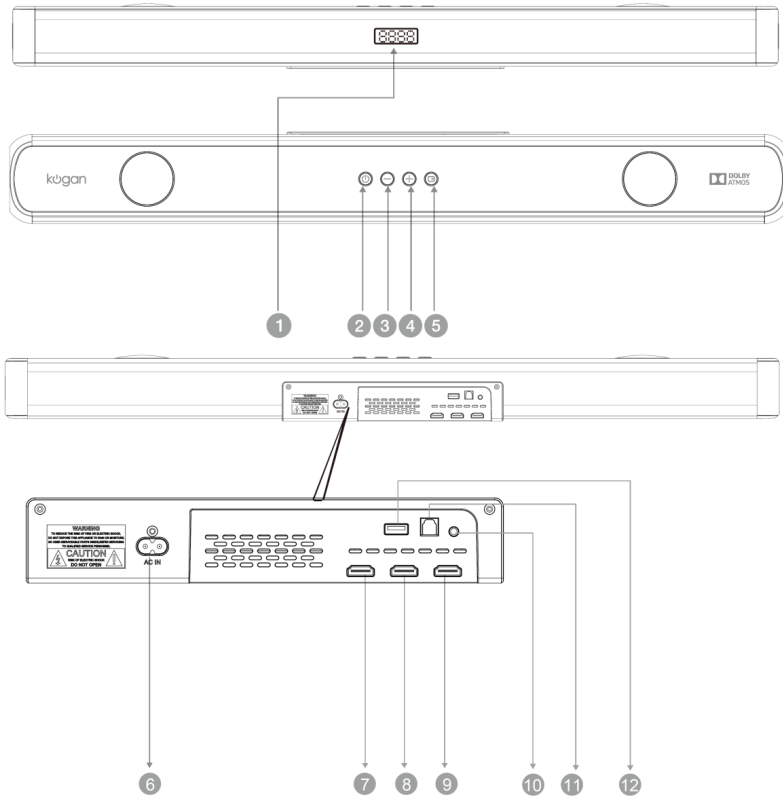

1	Display panel	7	HDMI IN 2: Connect to HDMI OUT of TV or satellite or network set-top box or BD/Blue Ray DVD player
2	Standby-on: Switch the Soundbar On or to standby	8	HDMI IN 1: Connect to HDMI OUT of TV or satellite or network set-top box or BD/Blue Ray DVD player
3	Volume: Decrease the volume	9	HDMI OUT (ARC): Connect to the HDMI input on the TV.
4	Volume: Increase the volume.	10	AUX IN: Audio input from a 3.5mm source (e.g. MP3 player)
5	INPUT: Select an input source.	11	TV IN OPTICAL: Connect to an optical audio output on the TV or a digital device.
6	AC IN: Connect to the power supply	12	USB PORT: Audio input from a USB storage device. Upgrade software of this product.

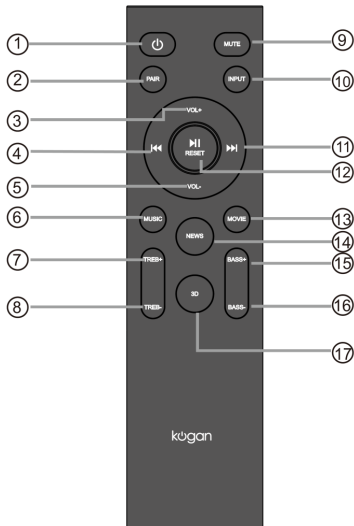

1	Power button: Press to switch the soundbar on/off or enter standby mode.
2	Pair button: <ul style="list-style-type: none"> • In Bluetooth mode, press and hold the pair button more than 2 seconds to connect and disconnect the last device. • In other modes, press the pair button to turn on or off surround function or effect and the display will show “on or off”.
3	VOL+: to increase the volume.
4	⏮ Previous button: Skip to the previous track in USB & BT mode.
5	VOL-: to decrease the volume.
6	Music button: to select and activate the music EQ effect and mode.
7	Treble+ button: to increase the treble volume.
8	Treble- button: to decrease the treble volume.
9	Mute button: Temporarily mutes the sound. Press again to turn the sound back on.
10	Source input button: Selects an input source; ARC, HDMI, Bluetooth, AUX, USB, Optical
11	⏭ Next button: Skip to the next track in USB & BT mode.
12	▶ Play/Pause button: Start, pause, or resume play in USB & BT mode. Reset button: Press and hold for more than 2 seconds to restore factory default settings.
13	Movie button: To select and activate the movie EQ effect and mode.
14	News button: To select and activate the news voice EQ effect and mode.
15	Bass+ button: To increase the bass.
16	Bass- button: To decrease the bass.
17	3D button: To select and activate the 3D EQ effect and mode.

INSTRUCTION

- Remove the soundbar from the carton and remove all packing material from the soundbar. Save the packing material, if possible, in case the soundbar ever needs to be serviced or transported. The original carton and packing material are the only safe way to pack your soundbar to protect it from damage in transit.
- Remove any descriptive labels or stickers on the front or top of the cabinet. Do not remove any labels or stickers from the back or bottom of the cabinet.
- Place your soundbar on a level surface such as a table, desk, or shelf, out of direct sunlight and away from sources of excess heat, dirt, dust, moisture, humidity, or vibration.
- Unwind the cord connecting the AC adapter and extend it to its full length.

This model is equipped with non-skid rubber 'feet' to prevent the product from moving when you operate the controls. These 'feet' are made from non-migrating rubber material specially formulated to avoid leaving any marks or stains on your furniture. However certain types of oil-based furniture polishes, wood preservatives or cleaning sprays may cause the rubber 'feet' to soften and leave marks or rubber residue on the furniture. To prevent any damage to your furniture, it is strongly recommended that you purchase small self-adhesive felt pads, available at hardware stores and home improvement centre everywhere and apply these pads to the bottom of the rubber 'feet' before you place the unit.

Operating range of the remote control

- When the unit is mounted on a wall, point the remote control at the remote-control sensor on the bellowed panel.
- Even if the remote control is operated within the effective range of 32.8 feet (10m), remote control operation may be impossible if there are any obstacles between the unit and the remote control.
- If the remote control is operated near other products which generate infrared rays or if other remote-control devices using infra-red rays are used near the unit, it may operate incorrectly. Conversely, the other products may operate incorrectly.

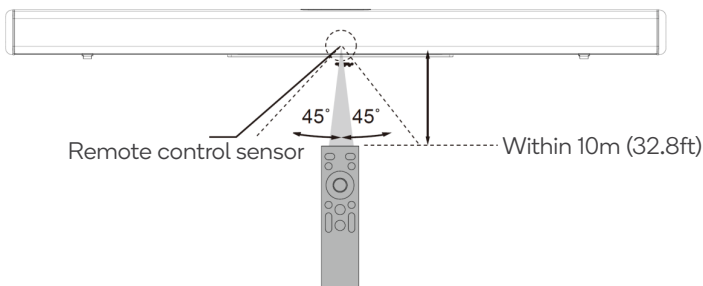

INSTALLATION

Table placement

Place the soundbar horizontally on a solid surface such as a TV unit or shelves and align it centrally with the TV screen.

For best sound output and good airflow around the soundbar, place your soundbar as shown in the image to the right.

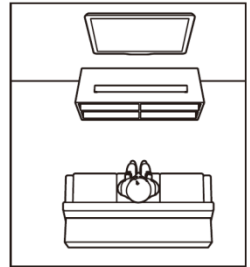

Wall mount installation

- Drill 4 holes in the wall, referring to the metal bracket for spacing, ensuring the holes correspond to the distance between soundbar pads.
- Fix the plastic anchors in the 4 holes of the wall mounting bracket.
- Fix the screws on the plastic anchor and tighten the screws to ensure that the wall mounting bracket will not shake.
- After fastening the screws, put the soundbar pads into the extension of the wall mounting bracket.

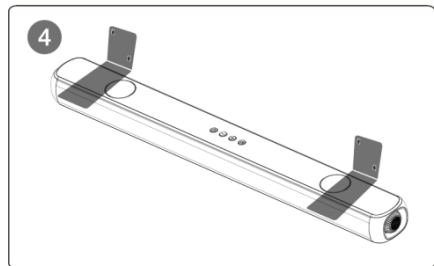
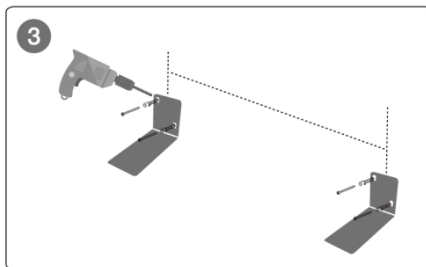
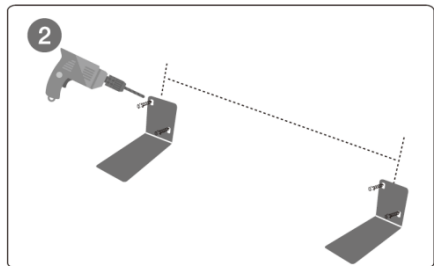
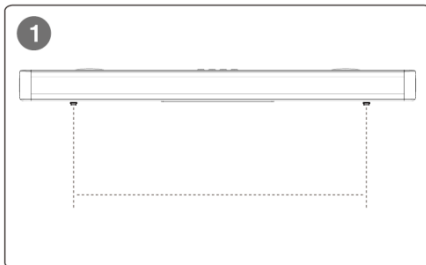

OPERATION

Using the soundbar

- Before connecting the AC power cord, ensure you have completed all other connections.
- Risk of product damage: Ensure that the power supply voltage corresponds to the voltage printed on the back or the underside of the unit.
- Connect the mains cable to the AC IN of the unit and then into a mains socket.

Basic operation

1. Press the power button on either the remote control or the sound bar to turn on the sound bar.
2. Switch on the connected device (such as TV, playback device, game console etc).
3. Press the input button on either the remote control or the sound bar to select your desired input source.

HDMI 1 & HDMI 2	Sound from a connected device (via HDMI IN port)
ARC/Optical	Audio from TV (via HDMI ARC port or TV IN (OPT) jack)
AUX	Sound from a connected device (via AUX port)
BLUETOOTH	Sound from a Bluetooth connected device
USB	Sound from a USB storage device

Power on and off

1. Plug-in the power cord with one side to AC IN on the soundbar and the other side to an AC wall outlet (see the following diagram). When you connect the soundbar to the main socket, the unit will be in standby mode.
2. Switch on the soundbar by short-pressing the power button on the soundbar or remote control, and a welcome message will scroll across the display. After 12 seconds, the default input mode will automatically appear on the display screen.
3. Press and hold the Power button on the soundbar or remote control for 2 seconds to switch it off and then disconnect the main plug from the main socket if you want to switch the unit off completely.

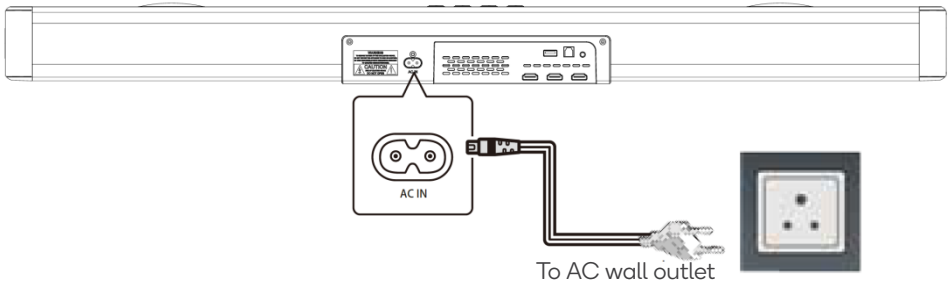

Select mode

Press the INPUT button on the soundbar or remote control to select between BT, AUX, OPTICAL, HDMI ARC, HDMI 1, HDMI 2, USB modes.

The selected mode will show on the display:

- **bLUE**: Bluetooth Pairing mode,
- **AUX**: AUX mode
- **OPTI**: Optical mode
- **Hd 1**: HDMI 1 mode,
- **Hd 2**: HDMI 2 mode,
- **ARC**: HDMI OUT (ARC) mode,
- **USB**: USB mode
- **ON**: Surround on/ **OFF**: Surround off

Playing audio via Bluetooth



Through Bluetooth, connect the soundbar with your Bluetooth device (such as an iPad, iPhone, iPod touch android phone or laptop) and you can listen to audio files on the device through your soundbar.

Requirements:

- A Bluetooth device which supports Bluetooth profile A2DP, AVRCP and with Bluetooth version 5.0 or later.
- The maximum operational range between the soundbar and a Bluetooth device is approximately 10 meters (30 feet).

1. Turn on the soundbar and press the INPUT button on the soundbar or remote control to switch the soundbar to Bluetooth mode. The display on the soundbar will show “**BLUE**” and begin flickering to show Bluetooth pairing mode.
2. On the Bluetooth device, switch on Bluetooth, search for and select KASBDA20CA on your Bluetooth list to start connection (see the user manual of the Bluetooth device on how to enable Bluetooth). If prompted for a password, use “0000”.
3. Wait until you hear the voice prompt from the soundbar. If successfully connected, “**BLUE**” will stop flickering and is displayed on the display panel.
4. Select and play audio files or music on your Bluetooth device.
 - During play, if a call is coming, music play is paused. Play resumes when the call ends.
 - If your Bluetooth device supports AVRCP profile, on the remote control you can press to skip to a track or short-press to pause/resume play. Hold the PAIR button on the remote control for more than 2 seconds to disconnect the paired Bluetooth device, or reconnect the most recent Bluetooth device.
5. You can use the volume buttons on the soundbar or on the remote control to adjust the volume to your requirements.
6. To exit Bluetooth, select another input source.
 - When you switch back to Bluetooth mode, the Bluetooth connection will remain active.

Note:

- If you experience connection problems, remove KASBDA20CA from your device's Bluetooth history and ensure it is less than 10 meters from the soundbar, then try pairing again. To get the best sound quality, make sure there is a clear line of sight between the connected device and your sound bar.
- If your pairing device or connected device is switched off or manually disconnected, the soundbar will automatically enter pairing mode.
- The music streaming may be interrupted by obstacles between the device and soundbar, such as a wall, metallic casing that obscures the device or other devices nearby that operate in the same frequency.
- If you want to connect your soundbar with another Bluetooth device, press and hold PAIR on the remote control to disconnect the currently connected Bluetooth device.

Connections

The HDMI in and HDMI (ARC) ports support both video & audio.

- Video: max. 1080p/4K/HDR/60fps
- Audio: Dolby Atmos, Dolby Digital, Dolby Digital Plus, Dolby TrueHD and Dolby Surround
- HDMI: HDMI version 2.0

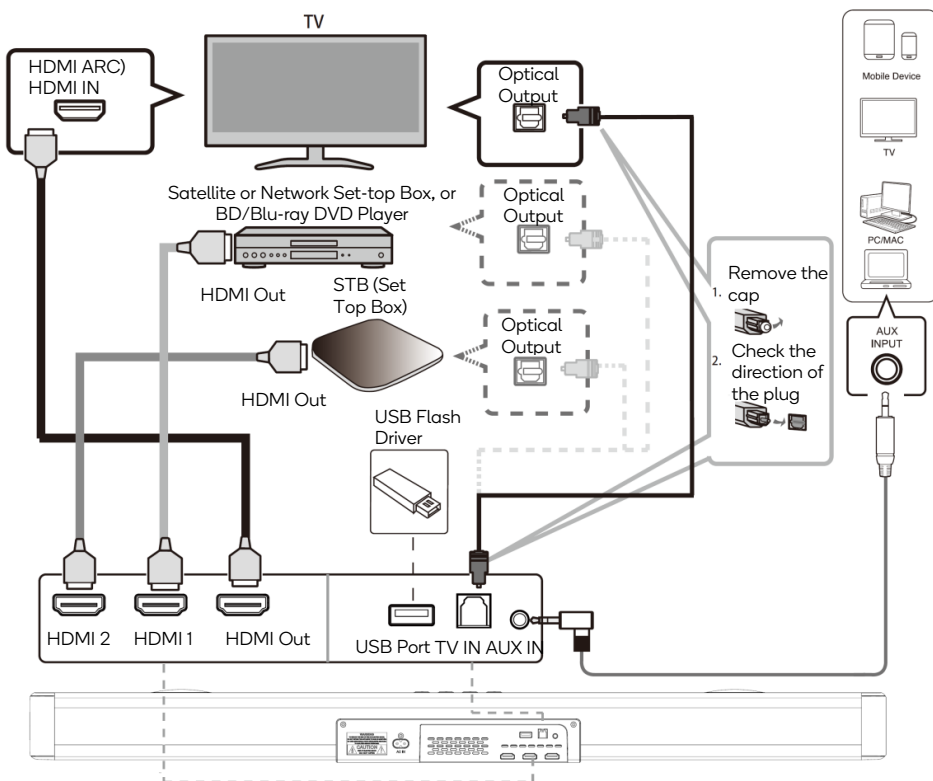

Playing audio via USB port

The soundbar automatically switches to USB input mode (with the LED display showing “USB”) when a USB flash drive is inserted. This mode is not selectable on the soundbar or remote control unless a USB flash drive is connected.

1. Ensure that your USB flash drive contains MP3 or WMA audio files (other file types not supported).
2. Connect the USB flash drive to the USB port on the soundbar (or your USB extension cable connected to the USB port); music will automatically play with the LED display showing “00:00”, and the playtime will be automatically displayed on the screen.
3. Press the VOL +/- buttons to adjust the volume to your desired level.
4. During playback:

 Start, pause, or resume play.

 Skip to the previous or next track.

Playing audio via audio input (AUX) connection

- Use a 3.5mm to 3.5mm audio cable (included) to connect the PC, tablet, smartphone, TV’s headphone socket etc. to the AUX IN socket on the soundbar.
- Use an RCA to 3.5mm audio cable (not included) to connect a Blu-ray player/TV’s audio output sockets to the AUX IN socket on the soundbar.
- Short-press the button on the soundbar or the remote control to switch to AUX input mode on the LED display.
- In this mode, playback can only be controlled on the connected device.

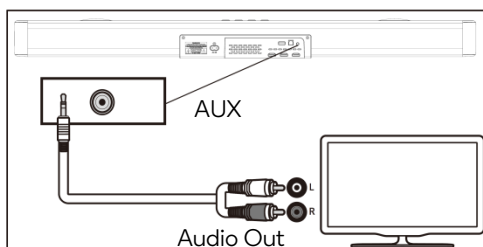
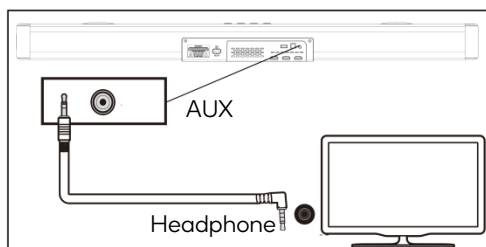

Note:

For some computers, you may need to access the audio control panel to manually select the soundbar as the audio playback device.

Optical mode

Using an optical cable (not included), connect the OPTICAL connector on your soundbar (Optical digital input) to the OPTICAL OUT connector on the TV or other device. The TV or other device must have an optical digital output.

- Connect the optical cable to the TV IN (OPT) jack on the rear of the soundbar.
- Connect the other end of the optical cable to the audio output jack on the TV.
- Switch the TV setting and sound bar on. Set the connected TV to “PCM Stereo” or “Stereo 2.0”.
- Start playback on the TV.
- Press the source input button on the soundbar or remote control to activate OPTICAL mode. After successfully connecting, the LED display will show “OPTI.”. Operate your audio device directly for playback features.
- Press the VOL +/- buttons to adjust the volume to your desired level.

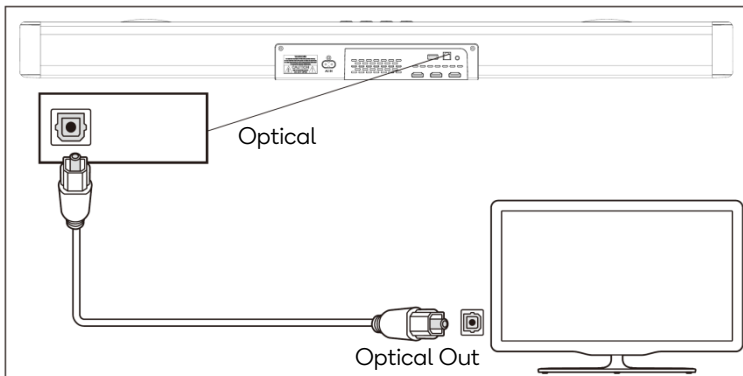

HDMI IN & HDMI (ARC) modes

Option 1: ARC (Audio Return Channel)

The soundbar supports HDMI with Audio Return Channel (ARC). If your TV is HDMI (ARC) compliant, you can hear the TV audio through your soundbar by using a single HDMI cable.

1. Using a high-speed HDMI cable, connect the HDMI OUT (ARC) on the soundbar to the HDMI (ARC) connector on your TV.
2. Press the INPUT button on the soundbar or remote control to switch to HDMI (ARC) mode. After successfully connecting, the LED display will show **"ARC"**.
3. Press the VOL +/- buttons to adjust the volume to your desired level.
4. If you wish, you can change the audio settings by using the relevant buttons on the remote control.

Note:

- Your TV must support the HDMI-CEC and ARC function. HDMI-CEC and ARC must be set to be on.
- The setting method of HDMI-CEC and ARC may differ depending on the TV. For details about ARC function, refer to your TV owner's manual.
- Only HDMI 1.4 (or later) compatible cables can support the ARC function.
- The Audio Return Channel (ARC) function enables an HDMI compatible TV to send the audio stream to HDMI OUT of the unit.

Option 2: Standard HDMI

- If your TV is not HDMI ARC-compliant, connect your soundbar to the TV through a standard HDMI connection.
- Use an HDMI cable (not included) to connect the soundbar's HDMI OUT socket to the TV's HDMI IN socket.
- Use an HDMI cable (not included) to connect the soundbar's HDMI IN (1 or 2) socket to your external devices (e.g. games consoles, DVD players and Blu-ray).
- Press the input button on the soundbar or remote control to switch to HDMI mode.
- After successfully connecting, the LED display will show or **HDMI 2**.

Note:

To play Dolby ATMOS signals to the soundbar:

1. Set the ATMOS device's audio output to be "auto" or original code.
2. Connect the device's HDMI OUT to the soundbar's HDMI 1 or 2 input.
3. Connect the soundbar HDMI OUT (ARC) to the TV's HDMI IN.
4. If connecting the device's HDMI OUT to a TV, connect the TV's HDMI ARC to the ATMOS HDMI ARC port to share control with the soundbar (only power on/off, previous/next track, mute and volume of soundbar can be controlled by your TV remote). The device's Optical output can be sent to the soundbar as a Dolby Digital Plus signal, as Dolby ATMOS signals require large bandwidth and cannot transfer by Optical or HDMI ARC.

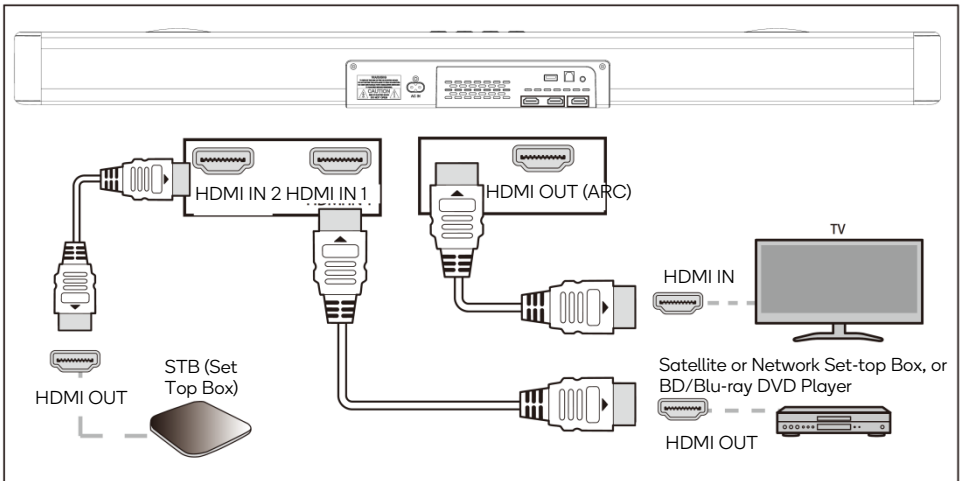

Note:

- While in OPTICAL/HDMI ARC mode, if there's no sound output from the unit and the status LED display flashes, you may need to activate PCM or Dolby Digital signal output on your source device (e.g. TV, DVD or Blu-ray player).
- The unit may not be able to decode all digital audio formats from the input source. In this case, the unit will mute. This is NOT a defect. Ensure that the audio setting of the input source is set to PCM or Dolby Digital with HDMI 1/HDMI 2/HDMI ARC/optical input.



Manufactured under license from Dolby Laboratories. Dolby, Dolby Audio, Dolby Vision, Dolby Atmos and the double -D symbol are trademarks of Dolby Laboratories.

Using DOLBY ATMOS®:

DOLBY ATMOS is only available in HDMI IN and HDMI OUT (ARC) mode.

1. To use Dolby Atmos® in HDMI 1/HDMI 2/HDMI ARC mode, your TV must support Dolby Atmos®.
2. Make sure that “No Encoding” is selected for bitstream in the digital audio output of the connected external device (e.g. Blu-ray DVD player, TV etc.).
3. While entering Dolby Atmos/Dolby Digital Plus format, the soundbar will show DOLBY ATMOS/DOLBY SURROUND.
4. Set the audio output sampling rate to 192 kHz if possible.

This sound bar supports 4K pass-through and DOLBY VISION. When you play a disc which supports 4K video signal, the signal can be delivered to your TV.

Note:

The full Dolby Atmos experience is only available when the Soundbar is connected to the source via a HDMI 2.0 cable.

The soundbar will still function when connected via other methods (such as a Digital Optical cable) but these are unable to support all the Dolby features. Given this, our recommendation is to connect via HDMI, to ensure full Dolby support.

Select equalizer (EQ) effect

Press the EQ button on the remote control to select your desired preset equalizer effects: Movie/Music/News/3D:

Music mode	Enhances the treble and adds greater depth to the music
Movie mode	Intensifies the bass and enhances the clarity of dialogue
News mode	Enhances the clarity of voices. Suitable for watching TV shows and news.
3D mode	Enhances background music and provides a full range of sound.

Adjust the volume

Press VOL+/- buttons on the unit or remote control to increase or decrease the volume level.

- To mute sound, press Mute.
- To restore the sound, press Mute again or press VOL+/-.

Adjust the bass/treble level

Press Bass+/- on the remote control to activate the bass level setting.

- The display will show **b +5** / **b -5** accordingly.

Press Treble+/- on the remote control to activate the treble level setting.

- The display will show **T +5** / **T -5** accordingly.

TROUBLESHOOTING

Problem	Cause	Remedy
The unit cannot be operated using the remote control.	The unit is out of the operating range.	Use the remote control within the operating range.
	The batteries are drained.	Replace with new batteries.
	The remote-control sensor of the unit is exposed to direct sunlight or strong lighting.	Adjust the lighting angle or reposition the unit.
The TV cannot be operated using the TV's remote control.	The unit is blocking the TV's remote-control sensor.	Position the unit so that it does not obstruct the TV's remote-control sensor.
The unit cannot be connected to a Bluetooth device.	Bluetooth is not selected as the input source.	Select Bluetooth as the input source.
	The unit is connected to a different Bluetooth device.	Unpair the Bluetooth device that is currently connected and pair with the desired Bluetooth device.
	The unit is too far away from the Bluetooth device.	Move the Bluetooth device closer to this unit.
	A device emitting electromagnetic waves (such as a microwave oven) may be located nearby.	Do not use this unit near devices that emit electromagnetic waves.
	The Bluetooth device you are using may not support the correct protocol.	Use a supported Bluetooth device.
	The connection profile registered in the Bluetooth device may not be functioning correctly.	Delete the connection profile in the Bluetooth device then reconnect the device to this unit.
No sound can be heard, or the sound cuts off intermittently.	The volume on the Bluetooth device may be too low.	Raise the volume on the Bluetooth device.
	Bluetooth is not selected as the input source.	Select Bluetooth as the input source.
	Playback on the device has not been started.	Begin playback on the device.
	The sound output on the Bluetooth device may not be set to this unit.	Select this unit as the output destination on the Bluetooth device.
	The connection to the Bluetooth device was cut off.	Connect with the Bluetooth device again
	The unit may be too far away from the Bluetooth device.	Move the Bluetooth device near this unit.

	A device emitting electromagnetic waves (such as a microwave oven, a wireless device and so on) may be located nearby.	Do not use this unit near devices that emit electromagnetic waves.
No sound.	Another input source is selected.	Select an appropriate input source.
	The mute function is activated.	Cancel the mute function.
	The volume is too low.	Turn up the volume.
	The power cable of the unit is not connected properly.	Make sure that the power cable of the unit is connected to an AC wall outlet securely.
	Input jacks on playback device are not connected.	Connect the input jack on the unit and the output jack on the playback device.
	Signals that the unit cannot playback are being inputted.	Change the digital audio output setting on the playback device to PCM.
The volume decreases when the unit is turned on.	The automatic volume adjustment function is activated. To prevent excessive loudness, the unit automatically controls its volume within a certain level when the unit is turned on.	Turn up the volume as required.
No surround effects.	The volume is too low.	Turn up the volume.
	The TV or playback device is set to output 2 channel audios (such as PCM) only. The TV or playback device is set to output 2 channel audios (such as PCM) only.	Change the digital audio output setting on the TV or playback device to Bitstream.
	Sound is also heard from the TV built-in speakers.	Set the TV volume to a minimum.
	The listening position is too close to the unit.	The listening position should be at some distance from the unit.
Noise is heard.	The unit is too close to another digital or high-frequency device.	Move those devices away from the unit.
Volume drops in and out when soundbar connected to TV via HDMI ARC.	Your TV HDMI ARC is not compatible with soundbar HDMI ARC.	You can select Optical as the input source to reproduce TV sound via soundbar Optical input.
	Your TV can not support HDMI-CEC and ARC function.	

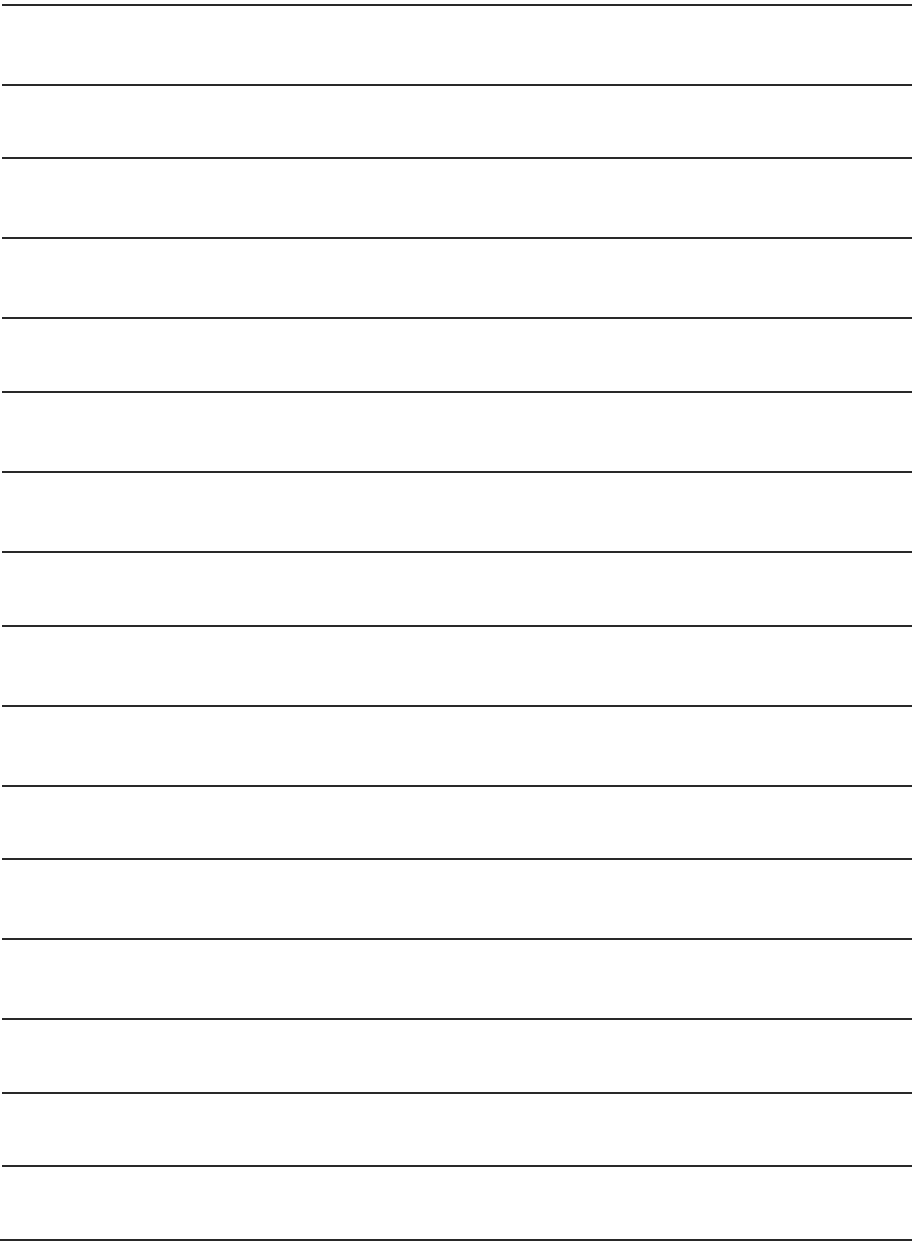

Need more information?

We hope that this user guide has given you the assistance needed for a simple set-up. For the most up-to-date guide for your product, as well as any additional assistance you may require, head online to **help.kogan.com**

kogan