

# kugan

## Wireless Digital Doorbell Set KAWLSDBELLC Quick Start Guide

### Parts

#### Receiver

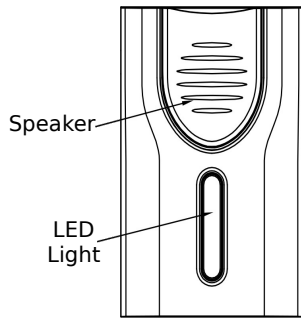

**Front View**

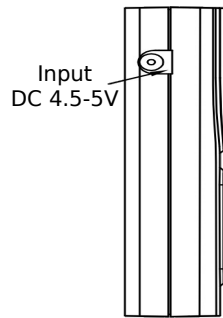

**Left View**

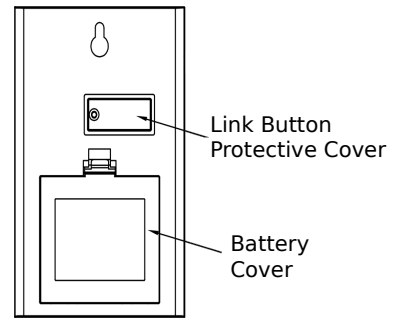

**Rear View**

#### Remote Control

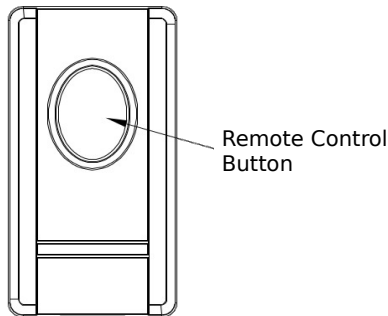

**Front View**

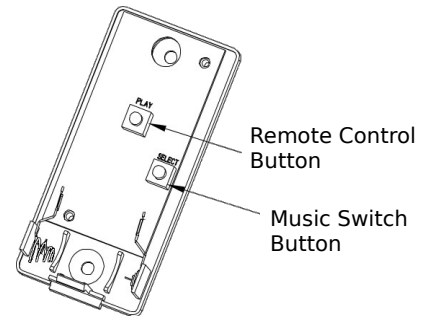

**Inner View**

### Linking Units

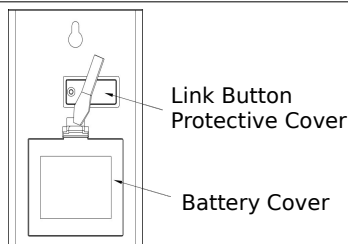

Open the link button protective cover and the battery cover with a screwdriver and install the battery.

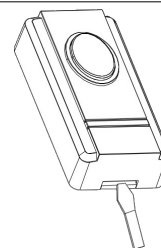

Open the remote control cover with a screwdriver and install the battery.

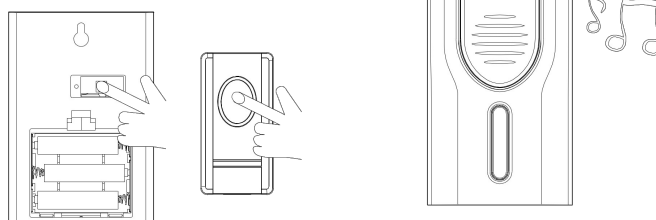

Press the linking button and the remote control button at the same time until the receiver rings. The units are now linked!

# **This product requires button batteries to operate which are hazardous to young children.**

## **WARNING – KEEP BATTERIES OUT OF REACH OF CHILDREN**



- Swallowing may lead to serious injury in as little as 2 hours or death, due to chemical burns and potential perforation of the oesophagus.
- If you suspect your child has swallowed or inserted a button battery immediately call the 24-hour Poisons Information Centre on 13 11 26 for fast, expert advice.
- Examine devices and make sure the battery compartment is correctly secured, e.g. that the screw or other mechanical fastener is tightened. Do not use if compartment is not secure.
- Dispose of used button batteries immediately and safely. Flat batteries can still be dangerous.
- Tell others about the risk associated with button batteries and how to keep their children safe.