

Portable Aluminium Folding Table KDTBLFLDC4A Quick Start Guide

SETUP METHOD

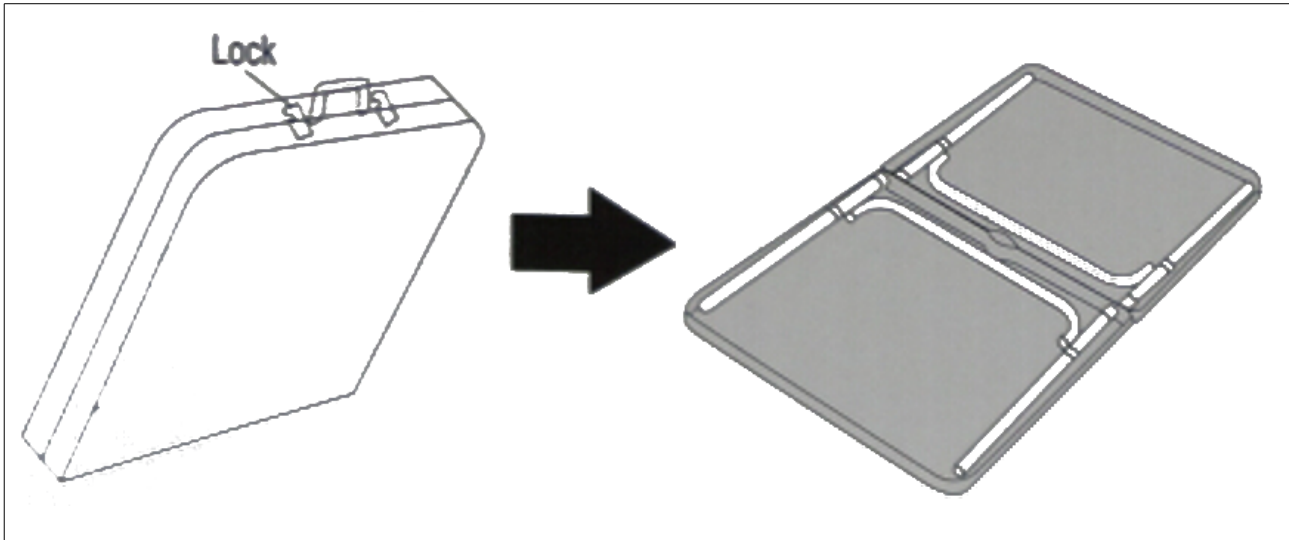

1 - Unlock the latches and open the table outwards. Place it upside-down on the ground.

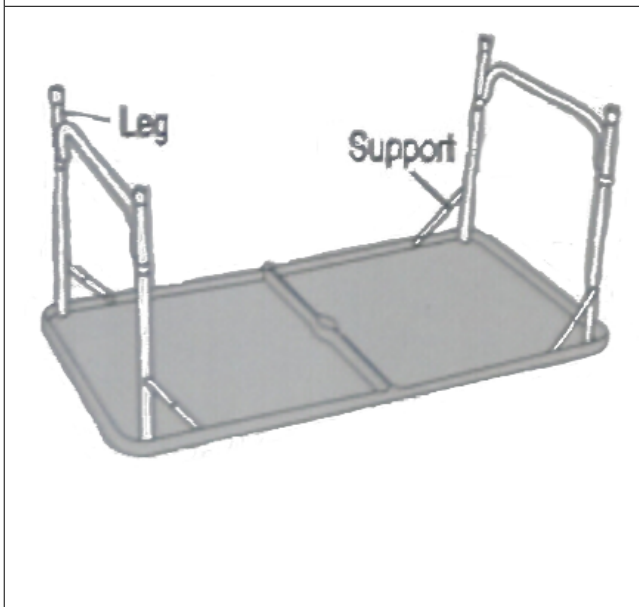

2 - Extend the legs outwards and lock supports.



3 - Turn table onto it's feet and it's ready to use!

ADJUSTING HEIGHT

Press lockbolt, then pull the leg out until the lockbolt reaches the next hole and snaps out into position.

Note: When adjusting the height, please have the table lying upside-down. Do not adjust the height while the table is standing.

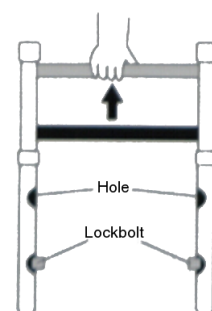

WARNING!

