

REMINGTON®

smooth & silky®

Ultimate Cordless Wet/Dry Epilator

USE & CARE
MANUAL

PLEASE READ
PRIOR TO USE



To register your product go to
www.remington-products.com.au
www.remington.co.nz

2 YEAR WARRANTY

EP7036AU

IMPORTANT SAFETY INSTRUCTIONS

When using electrical appliances, especially when children are present, basic safety precautions should always be followed, including the following:

READ ALL INSTRUCTIONS BEFORE USING

KEEP THE POWER ADAPTOR AWAY FROM WATER

Remington strongly recommends that an approved Safety Switch (residual current device) should protect all bathroom power outlets. Ask an electrical contractor for advice.

- To prevent accidents keep the appliance away from hair on your head, your eyebrows, eyelashes as well as clothes, brushes and wire.
- Your appliance should never be left unattended when plugged in to a power outlet.
- Always unplug the appliance when it is not in use.
- This appliance should not be used by children or other persons with reduced physical, sensory or mental capabilities or lack of experience and knowledge unless they have been given supervision or instruction concerning use of the appliance in a safe way and understand the hazards involved.
- This appliance is not a toy. Children shall be supervised to ensure they do not play with the appliance. Cleaning and user maintenance shall not be made by children without supervision.
- Use this appliance only for its intended use as described in this manual. Do not use attachments not recommended by Remington.

- Never operate this appliance if it has a damaged cord or plug, if it is not working correctly, if mains adaptor has been dropped or damaged. If the cord of this power adaptor is damaged the power adaptor must be discarded. Handle cord carefully for long life and avoid jerking, twisting or straining especially at plug connections. The cord cannot be repaired.
- Keep the power adaptor cord away from heated surfaces.
- Do not use on people who are asleep.
- Never drop or insert any object into any opening of this appliance.
- Do not use outdoors or where aerosol (spray) products are being used or where oxygen is administered.
- Do not plug or unplug the appliance with wet hands.
- Do not wrap the cord of the power adaptor around the unit.
- Do not use if the tweezers are broken or damaged.

CAUTION:

- For your protection your epilator may slow down or even stop if it is pressed too firmly against the skin.
- Do not use the epilator on irritated skin or skin with varicose veins, rashes, spots, moles or wounds without consulting a doctor. People with reduced immune response, for example during pregnancy, or people who suffer from diabetes mellitus, haemophilia or immunodeficiency should consult their doctor before using this appliance.
- For hygiene reasons do not let another person use your epilator. It is recommended for use by one person only.

SAVE THESE INSTRUCTIONS

EP7036AU SMOOTH & SILKY® ULTIMATE CORDLESS WET/DRY EPILATOR

Use & Care Instruction Manual

Thank you for purchasing your new Remington® Ultimate Cordless Wet/Dry Epilator. This epilator will remove hair from the face, legs, arms, bikini line, and underarms, leaving your skin feeling soft and smooth. Also included is an exfoliating head, callus remover head and an interchangeable shaver head for sensitive areas, a bikini comb attachment for the shaver head, and 3 extra attachment caps for epilating different areas.



KEY PARTS

- | | |
|---|--------------------------------|
| 1. Gentle lift & grip tweezers | 9. Foil shaver head |
| 2. Perfect angle cap | 10. Bikini comb |
| 3. Head release button
(on rear - not shown) | 11. Massage cap with Aloe Vera |
| 4. Pivoting head | 12. Facial cap |
| 5. Precision light | 13. Exfoliating head |
| 6. On/Off button with 2 speed
selections | 14. Callus remover head |
| 7. Charging indicator light | Also includes: |
| 8. Power port | – Premium storage bag |
| | – Cleaning brush |
| | – Power adaptor |

GENERAL INFORMATION ON EPILATION

The Remington® Ultimate Cordless Wet/Dry Epilator has been designed to make the removal of unwanted hairs as efficient, gentle and easy as possible. The epilation head and various caps are especially designed to follow the contours of your body that channel fine, short and flat hair into the tweezer discs, leaving the skin silky smooth.

The rotating tweezers remove hair as short as 0.5mm. The hair is pulled out from the root.

If you have not used an epilator before, or if you have not epilated for a long period of time, it may take a short time for your skin to adapt to this type of hair removal system. The discomfort that you feel at first is considerably reduced overtime, as your skin adjusts to the process.

Using an epilator may cause reddening or irritation of the skin. This is a normal reaction and will disappear quickly. However you should contact your doctor if the irritation has not disappeared within 3 days.

All methods of hair removal from the root can result in in-grown hairs depending on the condition of the skin and the hair. Regular exfoliation with the exfoliating head will help to prevent in-grown hairs.

In some cases inflammation of the skin can occur when bacteria penetrates the skin (when gliding the appliance over the skin). Thorough cleansing of the epilation head and caps after each use will minimise the risk of infection.

SOME USEFUL TIPS

- When using an epilator for the first time, it is best to try it on a small area first. This will help the skin adjust to the process of epilation.
- The optimum length of the hair for epilation is 2 – 5mm. If hairs are longer we recommend that you shave or trim the hair first with a Remington® shaver or a Remington® bikini trimmer and epilate the shorter re-grown hairs after 1-2 weeks
- Take a warm bath or shower before epilating and exfoliate to remove the dead skin cells. This will ensure that your skin is pliable, making the epilation process less uncomfortable.
- It is advisable to epilate in the evening, so that any possible redness can disappear overnight.
- After using your epilator you can use a body cream or aloe lotion to soothe the skin and reduce irritation.
- Regularly exfoliate after epilation with the exfoliating head to avoid in-grown hairs.
- For facial use (upper lip and chin area) use the Facial cap only.

INSTRUCTIONS FOR CHARGING

Before using your Remington® Ultimate Cordless Wet/Dry Epilator for the first time, charge for 24 hours. For subsequent uses, charge for 4 hours before use. One full charge allows for 40 minutes of cordless usage time.

Ensure that the On/Off switch is in the Off position. Attach the power adaptor to the product and plug into any household (100-240V AC) power outlet. The charging indicator light will illuminate, to indicate that the battery is charging.

- Only use the power adaptor supplied with the epilator.
- Make sure that the epilator is turned off while charging.

NOTE: The epilator cannot be turned on while it is charging.

DO NOT attempt to operate your epilator when it is plugged into the charging adaptor.

- Your epilator will alert you when the battery charge is running low. The red indicator light will be illuminated to indicate low battery. When the low battery indicator is illuminated, you must return to charging mode.
- Your epilator cannot be overcharged.
- If the epilator is not going to be used for an extended period of time unplug it from the mains and store it.
- If the epilator is not used for a period of 2 – 3 months, fully recharge the epilator when you use it again.
- Always charge the epilator in a cool, dry place
- In order to preserve the life of the batteries, they should be fully discharged every six months and then fully charged for 4 hours.
- Always ensure that your hands, epilator and mains/charging adaptor are dry before charging.
- The Remington® Ultimate Cordless Wet/Dry Epilator cannot be used when attached to mains voltage (100-240 Volts) while it is charging.
- Do not charge the epilator in close proximity to water.

HOW TO USE YOUR EPILATOR

NOTE: THIS EPILATOR OPERATES IN CORDLESS MODE ONLY.

Before epilating, make sure your skin is clean, dry and free from creams or oils. Ensure that the On/Off switch is in the Off position. Turn the epilator on ensuring that you press the switch lock in with your thumb. Set to the desired speed. Low speed is recommended for fine hair and High speed is recommended for coarse hair or stronger hair growth.



Using your free hand, hold the skin taut so that the hairs stand upright. Position the epilator so that the stainless steel discs are at a 90° angle and flat against the skin. The Remington® epilator attachment heads are designed to ensure maximum contact to the skin to maximise the hair removal process. (Diagram A)

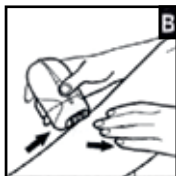

Glide the epilator in a slow continuous movement against the hair growth. Do not apply pressure as the epilator will slow down or even stop. Repeat until all unwanted hair is removed. After epilating, turn the epilator Off.

ARM/LEG EPILATION

Select and attach the Perfect angle cap, or Massaging cap with Aloe Vera to the epilator. Epilate from the lower arm or leg and slowly move upwards. To epilate behind the elbow or knee keep the arm or the leg straight to stretch the skin. (Diagram B)



FACE, UNDERARM & BIKINI EPILATION

Select and attach the Facial cap to the epilator. Please be aware that these areas are particularly sensitive to epilation. However this sensitivity will reduce after repeated usage. For more comfort, ensure that the skin is held taut and the hair is at the optimum length of 2-5mm.

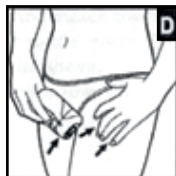

When epilating the underarm keep your arm raised so that the skin is stretched. Directly after epilation avoid using irritating substances, such as deodorants with alcohol. (Diagram C)

When epilating the bikini line hold the skin around the bikini line area taut, and glide the epilator in a circular motion. (Diagram D)

ATTACHMENTS

Your epilator comes with various different interchangeable heads. To attach the different heads press the head assembly release button and remove the current head. Attach the desired head by pushing it onto the body of the epilator until it clicks into place.

THE SHAVING HEAD ATTACHMENT

The shaver head allows you to shave sensitive areas or long hairs. To use, hold the shaver head at a right angle to the skin and glide it, with light pressure against the direction of the hair growth. To shave long hair, tip the shaver slightly, allowing the front trimmer to glide along the skin against the direction of the hair growth. After removing the long hairs, move the shaver across the skin gently so that the foils can remove any remaining hairs.

A bikini comb attachment is included for your shaver head. This allows you to trim hairs to a shorter length prior to epilating, or for shaping the hair to a desired length. To use the bikini comb simply attach it over the top of the shaver head and glide it over the hair at a right angle to the skin.

THE FACIAL CAP ATTACHMENT

An interchangeable Facial cap attachment is included with your epilator for smaller areas and spot treatments, such as the face, underarms and bikini line. To attach the Facial cap first remove the cap that is currently on the epilator. Align the Facial cap with the epilator and then gently push down until it locks into place. To use, hold the epilator at a right angle to the skin and glide it, with light pressure against the direction of the hair growth.

MASSAGE CAP WITH ALOE VERA

The massage cap is designed for a more gentle and comfortable epilation. Infused with Aloe Vera it soothes and calms your skin by gently stimulating and massaging as you epilate.

THE EXFOLIATING HEAD

The exfoliating head helps to prevent ingrown hairs and leave your skin smooth & silky.

NOTE: The exfoliating head is not to be used on the face or in sensitive areas.

CALLUS REMOVER HEAD

The callus remover head is a foot file which spins to remove hard skin leaving your feet looking beautiful.

NOTE: Do not use on wet skin.

NOTE: Allow the callus remover to glide along your skin, do not apply too much pressure against the skin.

MAINTENANCE

CLEANING THE EPILATOR HEAD AND ATTACHMENT CAPS

To ensure long lasting performance of your epilator it is important to clean the head assembly and attachments regularly. Always keep a cap on the epilation head when it is not in use to prevent damage to the barrel.

- Ensure that the epilator is turned off and disconnected from the mains.
- Pull the cap attachment away from the body of the epilator. (Diagram E)
- Using the cleaning brush provided brush the accumulated hair from the tweezers by slowly turning the barrel. Alternatively, remove the attachment cap from the body of the epilator and rinse the cap and barrel under running water.
- Replace the cap attachment back onto the body of the epilator.
- Alternatively you may also clean the tweezers using the cleaning brush dipped in alcohol. The cap attachments may be rinsed under warm water.

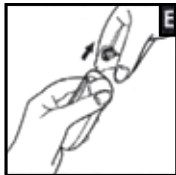

CLEANING THE SHAVING HEAD

To maintain peak performance it is important to clean the shaving head attachment regularly.

- Ensure that the epilator is turned off and disconnected from the mains.
- Press the head assembly release button and remove the shaving head from the body of the epilator.
- Remove the blade, foil and cutter assembly by placing your finger either side of the assembly and pulling upwards away from the shaver head.
- Gently shake the blade and trimmer assembly to remove the hair. Using the cleaning brush provided brush any loose hairs from the shaver housing. **DO NOT** use the cleaning brush to clean the foil. The shaver foil is easily damaged and must always be treated with care.
- Replace the blade, foil and cutter assembly by gently pushing it back into place.

LUBRICATING THE SHAVER HEAD

Once a month Remington recommends that after rinsing the epilation barrel or shaver head with water, that a light grade oil (such as sewing machine oil) be used to lubricate the attachment. Simply spread 1-2 drops lightly over the cutters or epilator barrel with your fingertip and wipe away all excess oil.

DO NOT use hair oil, grease or any oil mixed with kerosene or solvent as these will evaporate.

STORAGE

When not in use, always unplug the power adaptor from the power outlet. Never wrap the cord of the power adaptor around the unit as this will cause the cord to wear prematurely and break. Handle the cord carefully for long life and avoid jerking, twisting or straining especially at the power plug. If the cord becomes twisted in use, periodically straighten it.



SUITABLE FOR USE IN BATH OR SHOWER.

This appliance conforms to radio frequency interference requirements.

Any product purchases and used commercially carries a limited 90 Day Warranty.



MONEY BACK OFFER – AUSTRALIA / NEW ZEALAND ONLY

If within 90 days you are not fully satisfied with your Remington® epilator, just return the epilator with this completed coupon and a copy of your Australian/New Zealand purchase receipt to Remington®. In return, we will send you a cheque for the full purchase price of the epilator. Please allow 6-8 weeks for your cheque to arrive.

Name:

Address:

City:

State: Postcode:

Contact No: Area Code: Ph:

Product Model number:

Is this the first Remington epilator you have owned/purchased? Yes No

What is the reason you are returning this product?

Spectrum Brands Australia Pty Ltd and Spectrum Brands New Zealand Limited
WARRANTY AGAINST DEFECTS

In this warranty:

Australian Consumer Law means the Australian consumer law set out in Schedule 2 to the Competition and Consumer Act 2010;

CGA means the New Zealand Consumer Guarantees Act 1993;

Goods means the product or equipment which was accompanied by this warranty and purchased in Australia or New Zealand, as the case may be;

Manufacturer, We or us means:

1. for Goods purchased in Australia, Spectrum Brands Australia Pty Ltd ACN, 007 070 573; or
2. for Goods purchased in New Zealand, Spectrum Brands New Zealand Limited, as the case may be, contact details as set out at the end of this warranty;

Supplier means the authorised distributor or retailer of the Goods that sold you the Goods in Australia or in New Zealand; and

You means you, the original end-user purchaser of the Goods.

1. Our goods come with guarantees that cannot be excluded under the Australian Consumer Law, or the CGA. You are entitled to a replacement or refund for a major failure and compensation for any other reasonably foreseeable loss or damage. You are also entitled to have the goods repaired or replaced if the goods fail to be of acceptable quality and the failure does not amount to a major failure.
2. The benefits provided by this Warranty are in addition to all other rights and remedies in respect of the Goods which the consumer has under either the Australian Consumer Law or the CGA. The original purchaser of the Goods is provided with the following Warranty subject to the Warranty Conditions:
3. We warrant the Goods for all parts defective in workmanship or materials for the period of two (2) years from the date of purchase (**Warranty Period**). If the Goods prove defective within the Warranty Period by reason of improper workmanship or material, we may, at our own discretion, repair or replace the Goods without charge.

Warranty Conditions

4. The Goods must be used in accordance with the manufacturer's instructions. This Warranty does not apply should the defect in or failure of the Goods be attributable to misuse, abuse, accident or non-observance of manufacturer's instructions on the part of the user. As far as the law permits, the manufacturer does not accept liability for any direct or consequential loss, damage or other expense caused by or arising out of any failure to use the Goods in accordance with the manufacturer's instructions.
5. Exhaustible components (such as shaver heads, cutters and foils) of the Goods are included under this Warranty only where there is a defect in workmanship or materials used.
6. The warranty granted under clause 3 is limited to repair or replacement only.
7. Any parts of the Goods replaced during repairs or any product replaced remain the property of the manufacturer. In the event of the Goods being replaced during the Warranty Period, the warranty on the replacement Goods will expire on the same date as for the Warranty Period on the original Goods which are replaced.

8. In order to claim under the warranty granted under clause 3 you must:
 - (a) Retain this warranty with your receipt/proof of purchase; and
 - (b) Return the Goods to us at the relevant address below or to the Supplier by prepaid freight within the Warranty Period accompanied with (i) the legible and unmodified original proof of purchase, which clearly indicates the name and address of the Supplier, the date and place of purchase, the product name or other product serial number and (ii) this warranty.
9. This warranty is immediately void if:
 - (a) Any serial number or appliance plate is removed or defaced;
 - (b) The Goods have been serviced or otherwise repaired by a person not authorised to do so by us or where non approved replaced parts are used.
10. The Goods are designed for domestic use only. A limited 90-day Warranty applies to any industrial or commercial use of the Goods. The Goods must be connected to the electrical voltage requirements as specified in the ratings label located on the Goods.
11. This warranty does not cover the cost of claiming under the warranty or transport of the Goods to and from the Supplier or us.
12. This warranty is only valid and enforceable in Australia against Spectrum Brands Australia Pty Ltd and in New Zealand against Spectrum Brands New Zealand Limited.

Contact us or the Supplier for further details.

Spectrum Brands Australia Pty Ltd

Locked Bag 3004

Braeside, VIC 3195

AUSTRALIA

Customer service in Australia: 1800 623 118

E-mail: consumer.enquiry@remington-products.com.au

Website: www.remington-products.com.au

Spectrum Brands New Zealand Limited

PO Box 9817

Newmarket, Auckland 1149

NEW ZEALAND

Customer service in New Zealand: 0800 736 776

E-mail: info@remington.co.nz

Website: www.remington.co.nz

REMINGTON 

REMINGTON SERVICE HOTLINE

① Australia 1800 623 118 (toll free)

① New Zealand 0800 736 776 (toll free)

® Registered Trade Mark of Spectrum Brands, Inc. or one of its subsidiaries

Made in China to the Specifications of Spectrum Brands, Inc.

© 2016 Spectrum Brands, Inc.

REV: 10/16

PART NO: T22-0004663

